

- General Notes:**
1. This drawing is to be read in conjunction with all relevant Architects and Structural Engineers Construction issued drawings, Fire Certificate and Fire Drawings, along with the consultants Mechanical and Electrical specifications and any other documentation.
 2. Do not scale from this drawing. This drawing is representative only. All dimensions are in millimeters (mm), unless otherwise stated. Use the figured dimensions when shown.
 3. The exact location of all services and fittings to be agreed on site with the Architect and/or Structural Engineer prior to their installation.
 4. The Mechanical and Electrical Services are to be coordinated with all other trades and to be agreed on site prior to their installation. The contractor shall allow for the setting out and installation around all obstructions. Additional costs incurred by the contractor due to the lack of coordination will not be accepted.
 5. Connections to all equipment to be made by the contractor.
 6. Any discrepancies between this drawing and on site conditions must be reported to Renaissance Engineering LTD. immediately. Any changes from this design drawing must be agreed with the Engineer in writing. A failure to gain this approval could lead to difficulty in approving payment for the variations.
 7. Installation / Construction / As-Built Drawings to be prepared by the Mechanical/Electrical Contractor with reference to the latest Architects and Structural Engineers construction issue drawings and fire certificate drawings.
 8. All Electrical works to comply with the National Rules for Electrical Installations, 5th Edition ET101:2020.
 9. All Mechanical and Electrical works to comply with the current Building Regulations.

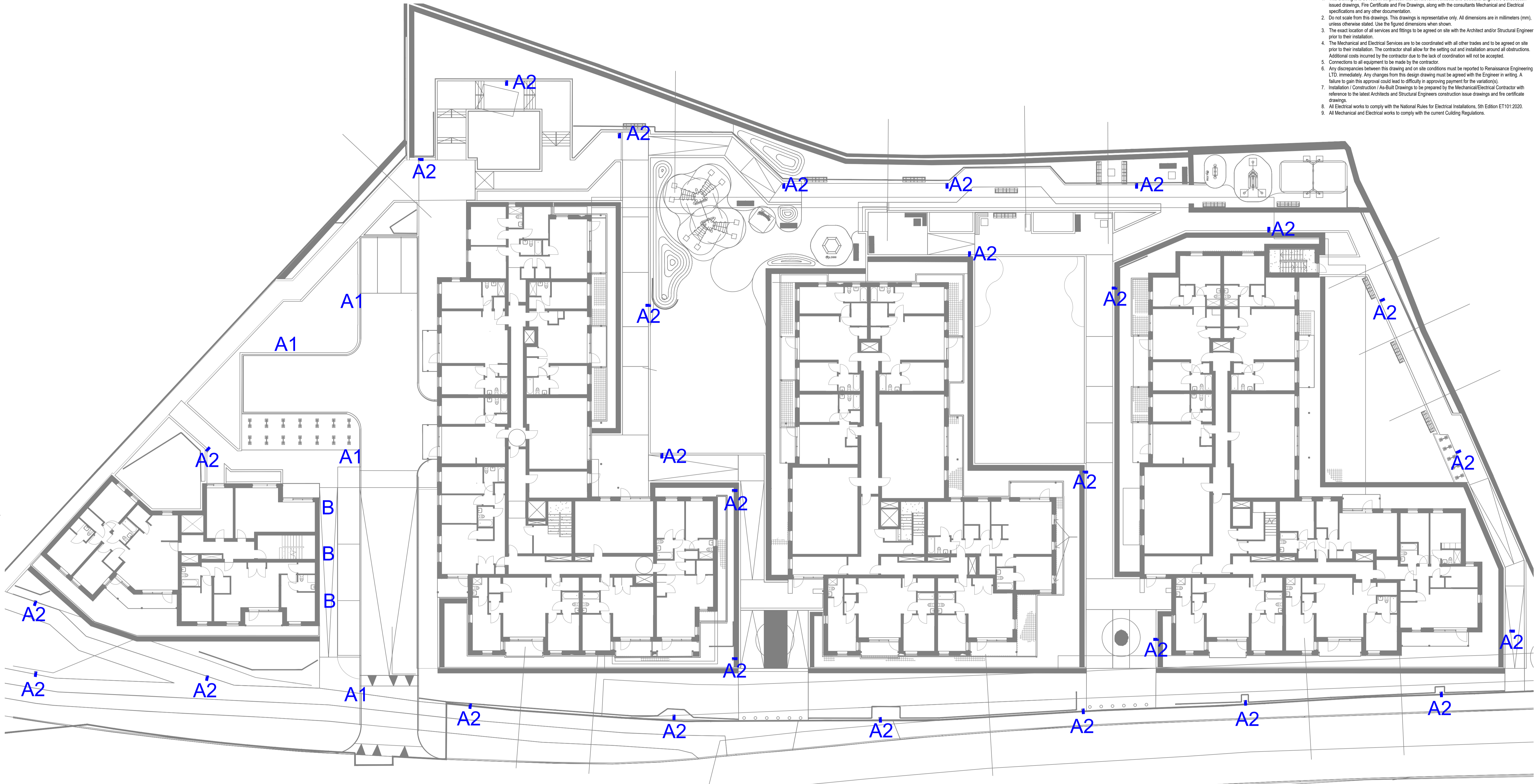

Note all Luminaires are at 3000° K

A1 Auva Road Light, 26W with LSM1 Optic.

A2 Auva Road Light, 18W with LSM2 Optic.

Luminaire Mounted on 6m Pole.
Tilted at 0°

B iPonte Wall Light, 12W Asymmetric

Lighting, Revision2 3000°K			
Area	Ave Lux	Min Lux	Uniformity
Roadway	14.7	5.5	0.38
Walkway A Lower	9.2	4.2	0.46
Walkway A Upper	9.5	3.6	0.38
Walkway B C D Lower	8.5	3.6	0.42
Walkway B C	8.2	2.3	0.28
Walkway C D	9.3	2.9	0.31
Walkway D Right	9.4	4.1	0.43
Walkway A B C D Upper	10.0	2.8	0.28
Block A Pedestrian Access	48.7	30.5	0.63

P01	20.04.22	Layout Updated	R.S.	D.S.
P	13.04.22	Preliminary Issue	R.S.	D.S.
Rev.	Date	Revision Description	Drn.	Chkd.

RE Renaissance Engineering
 Address: 2nd Floor, 67-70 Meath Street, Dublin 8, D08 YK4, Ireland
 Telephone: +353 (0)1 675 0650
 Email: info@reng.ie
 Web: renaissanceengineering.ie

Client: _____
 Architect: _____
 Job Title: Sandyford PRS Scheme

Drawing Title: Lighting Services Site Layout

Date: 13.04.22	Scale: 1:500	@A1	Drawing No.: 20219-REN-XX-SS-DR-E-6300	Revision: P01
Designer: R.S.	Checked: D.S.	Approved: S.M.	CAD Filename: 20219-REN-XX-SS-M2-E-6300.dwg	